



12 School Close, Westergate PO20 3AB

£265,000 Freehold



2 Bedrooms



1 Bathroom



2 Reception Rooms

SW

Sims Williams

## Key Features

- Mid Terrace House
- Good Size Lounge
- Conservatory
- Modern Fitted Kitchen
- 2 Double Bedrooms
- Family Bathroom
- Ground Floor Cloakroom
- Rear Garden
- Allocated Parking

## EPC Rating

Current = C

Potential = A

## Council Tax Band

Band = C

## Tenure - Freehold



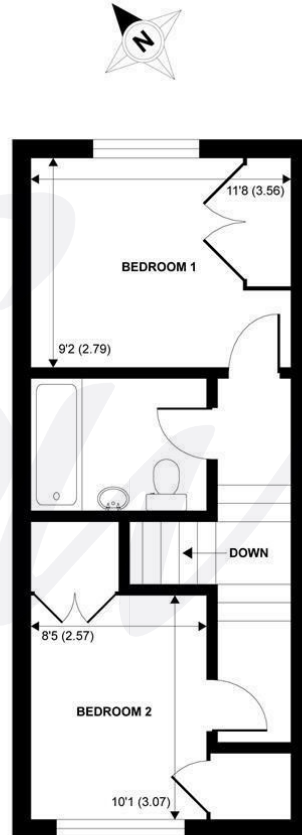
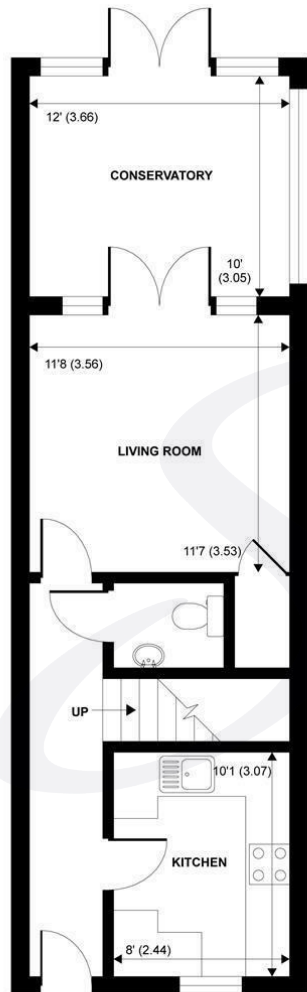

**GROUND FLOOR**

**FIRST FLOOR**

APPROX. GROSS INTERNAL FLOOR AREA 838 SQ FT 77.9 SQ METRES

NOT TO SCALE (For illustrative purposes only as defined by RICS Code of Measuring Practice) 2014©



[simswilliams.co.uk](http://simswilliams.co.uk)

#### CHICHESTER

---

8-9 Southgate

Sales 01243 787868

Lettings 01243 836055

[chichester@simswilliams.co.uk](mailto:chichester@simswilliams.co.uk)

#### WALBERTON

---

5 Maple Parade

Sales 01243 551368

Lettings 01243 836055

[walberton@simswilliams.co.uk](mailto:walberton@simswilliams.co.uk)

#### ARUNDEL

---

8a High Street

Sales 01903 885678

Lettings 01903 881133

[arundel@simswilliams.co.uk](mailto:arundel@simswilliams.co.uk)

#### BOGNOR REGIS

---

46 High Street

Sales 01243 862626

Lettings 01243 836055

[bognor-regis@simswilliams.co.uk](mailto:bognor-regis@simswilliams.co.uk)

Viewing Strictly by arrangement via the vendor's agent Sims Williams 01243 551368. These particulars are believed to be correct but their accuracy is not guaranteed and they do not form part of any contract.